

INSTALLATION DIMENSIONS

MODEL	(mm)			
	A	B	C	D
SSM-200N	64	51	22	M6 X 1 - 6H
SSM-500N, 1000N	64	51	19	M6 X 1 - 6H
SSM-2000N, 5000N,	76	51	32	M12 X 1.75 - 6H
SSM-20kN	89	64	44	M16 X 2 - 6H

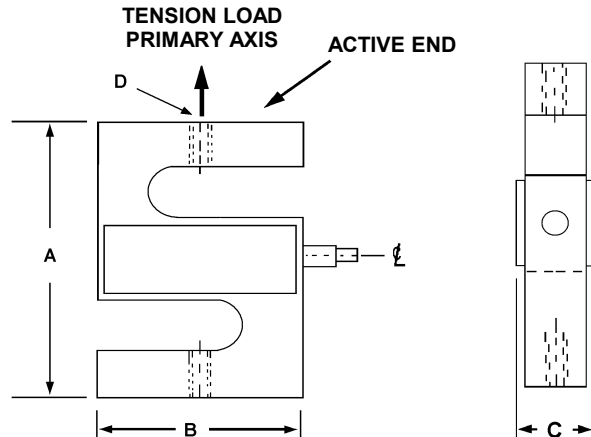

ELECTRICAL INFORMATION

The SSM-200N through SSM-1000N are supplied with a 4-conductor shielded cable (AWG 28) 3m long. The SSM-2000N through 20kN load cells are supplied with a rugged cable (PVC jacket AWG 22) 3m long or a Bendix PC04E-10-6P connector. A mating connector PC06W-106S is available at additional cost.

Wiring Color code complies with ISA 37.8 'Specifications and Tests for Straining Gage Force Transducers' and SMA Load Cell Terminology.

Connector		Cable	
PIN	Function	Color	Function
A	+ Excitation	Red	+ Excitation
B	+ Output	Green	+ Output
C	- Output	White	- Output
D	- Excitation	Black	- Excitation
E	No Connection	Shield	No Connection
F	No Connection		

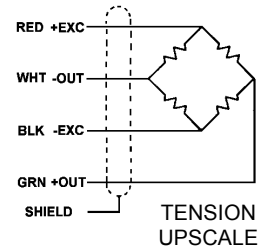

APPLICATION NOTES

1. The sealed Super-Mini load cell is specifically designed for outdoor usage and thus can be used in scale pits and batching plants or other locations that are directly exposed to the weather.

2. At least one diameter thread engagement is desirable; normal engagement is shown below:

SSM-200N, SSM-500N, SSM-1000N	6mm to 12mm
SSM-2000N, SSM-5000N, SSM-10kN	12mm to 16mm
SSM-20kN	16mm to 20mm

3. Jam nuts may be used, however care should be exercised to not apply excessive torque across the load cell. Torque should be reacted against the load cell structure immediately adjacent to the jam nut and should not exceed the following recommended torque:

SSM-200N	2.5Nm (0.2 kgm)
SSM-500N, SSM-1000N	4.5Nm (0.5 kgm)
SSM-2000N, SSM-5000N	22.5Nm (2.3 kgm)
SSM-10kN	90Nm (9.2 kgm)
SSM-20kN	113Nm (12 kgm)

4. The force to be measured should be applied to the active end of the cell to eliminate possible errors due to cable interaction. The active end of the cell is separated from the cable/connector side by the slot (cutout) in the flexure (the serial number is always shown on the inactive side).

Bottoming out the mounting stud can cause irreparable damage to the load cell.

PERFORMANCE DATA

Input Resistance Ohms	350 + 50 / - 3.5
Output Resistance Ohms	350 +/- 3.5
Recommended Excitation Vdc	10
Maximum Excitation VDC or VAC	15
Nonlinearity - % Rated Output	< +/- 0.05
Hysteresis - % Rated Output	< +/- 0.03
Temp. Range Compensated	-15 to 65°C
Temperature effect on zero - % Rated Output/55°C	+/- 0.15
Zero Balance - % Rated Output	< +/- 1

Warranty & Certification Statement on reverse side.

METRIC SEALED SUPER-MINI LOAD CELL

MODEL: SSM-AJ-1000N Date: 29-JUN-2015
CAPACITY: 1000 N Serial: 744740

OUTPUT, TENSION 3.11216 mV/V

Interface Inc.
Scottsdale, AZ, USA
Telephone (480) 948-5555 FAX (480)

